

# SSLB Cable Connectors

Click on part number to go directly to cable assembly instructions

## Straight Cable Plugs

Crimp type for flexible cable

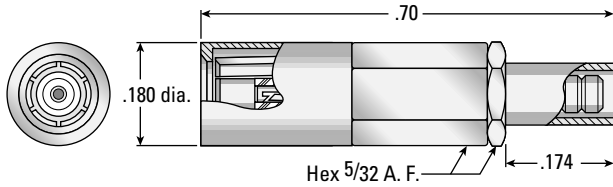

**AEP P/N**  
**7302-1572-0XX\***

Solder type for semi-rigid cable

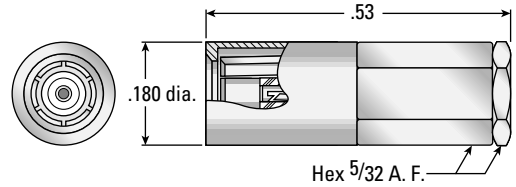

**AEP P/N**  
**7302-1542-0XX\***

## Right Angle Cable Plugs

Crimp type for flexible cable

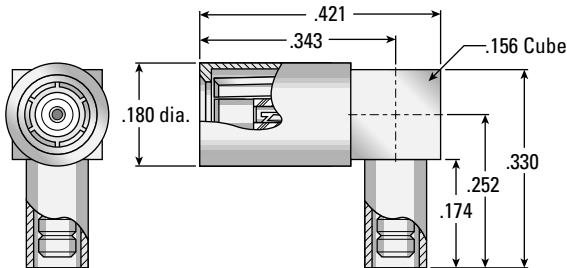

**AEP P/N**  
**7305-1521-0XX\***

Solder type for semi-rigid cable

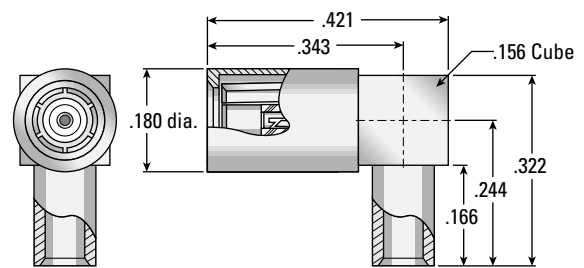

**AEP P/N**  
**7305-1561-0XX\***

## Right Angle Cable Jacks

Crimp type for flexible cable

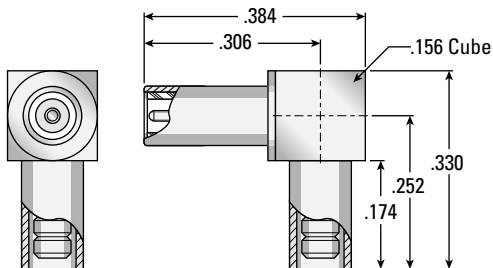

**AEP P/N**  
**7341-1521-0XX\***

Solder type for semi-rigid cable

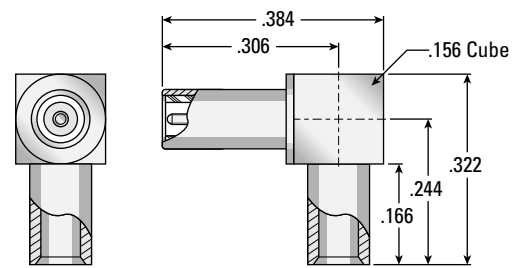

**AEP P/N**  
**7341-1561-0XX\***

\*Substitute the appropriate cable group number for "XX" when ordering:

GROUP	CABLE TYPES	GROUP	CABLE TYPES	GROUP	CABLE TYPES
02	RG178, RG196, M17/93, M17/169	05	RG178DS, RG196DS	19	RG174DS, RG316DS, M17/151, M17/152, Times RD-316
03	RG174, RG179, RG316, M17/113, M17/119, M17/172, M17/189	10	.085" semi-rigid, RG405, M17/133	21	.056" semi-rigid
		11	.047" semi-rigid, M17/151		



APPLIED ENGINEERING PRODUCTS

(203) 776-2813 • FAX (203) 776-8294

www.aepconnectors.com • aepsales@aepconnectors.com

# SSLB Cable Connectors

Click on part number to go directly to cable assembly instructions

## Straight Bulkhead Mounted Cable Jacks (.093" max panel thickness)

### Crimp type for flexible cable

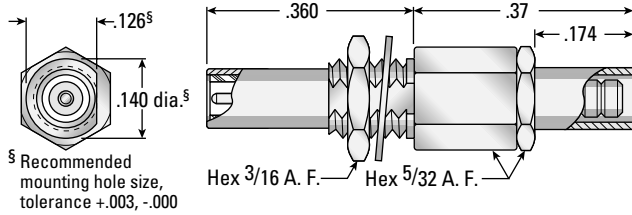

§ Recommended mounting hole size, tolerance +.003, -.000

**AEP P/N**  
**7303-1571-0XX\***

### Solder type for semi-rigid cable

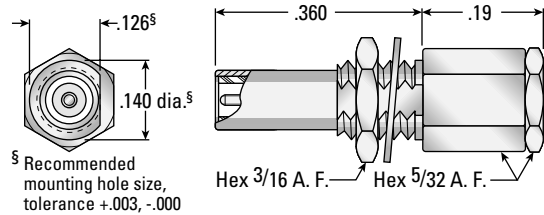

§ Recommended mounting hole size, tolerance +.003, -.000

**AEP P/N**  
**7303-1541-0XX\***

## Vibration-Proof Float Mounted Plug (See page 5 for details)

### Straight—crimp type for flexible cable

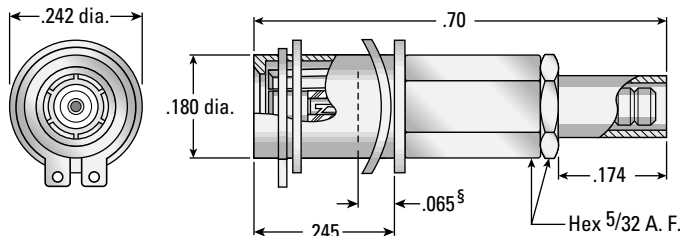

§ From internal mating plane (end of mating connector when fully engaged) to rear of panel

PANEL THICKNESS	AEP P/N
.050	7332-1572-0XX*
.093	7332-1572-3XX*

## Vibration-Proof Float Mounted Plug (See page 2 for details)

### Right angle—crimp type for flexible cable

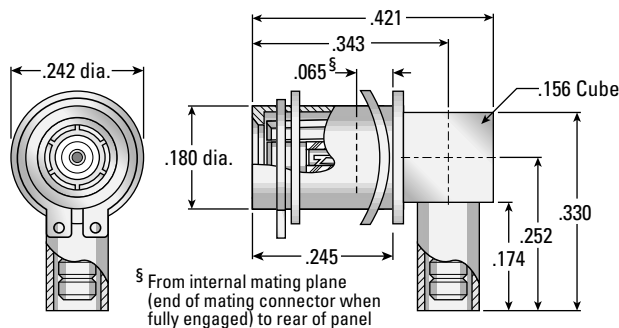

§ From internal mating plane (end of mating connector when fully engaged) to rear of panel

PANEL THICKNESS	AEP P/N
.050	7335-1521-0XX*
.093	7335-1521-3XX*

\*Substitute the appropriate cable group number for "XX" when ordering:

GROUP	CABLE TYPES	GROUP	CABLE TYPES	GROUP	CABLE TYPES
02	RG178, RG196, M17/93, M17/169	05	RG178DS, RG196DS	19	RG174DS, RG316DS, M17/151, M17/152, Times RD-316
03	RG174, RG179, RG316, M17/113, M17/119, M17/172, M17/189	10	.085" semi-rigid, RG405, M17/133	21	.056" semi-rigid
		11	.047" semi-rigid, M17/151		

# SSLB Bulkhead Mounted Receptacles

## Bulkhead Jack Receptacles (.093" max panel thickness)

### Straight

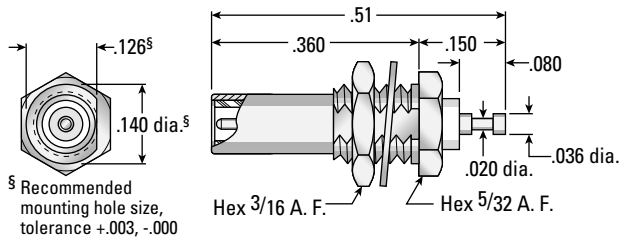

**AEP P/N**  
**7304-1511-000**

### Right angle

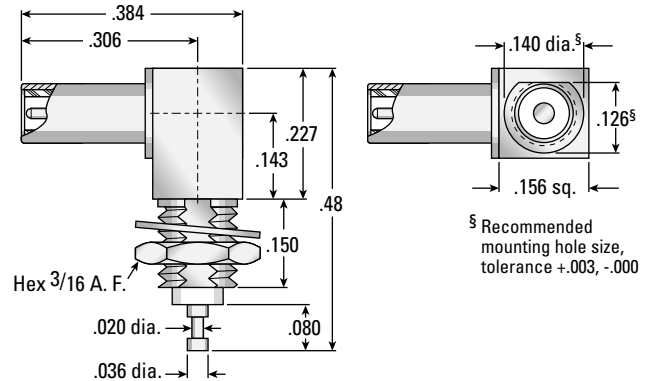

**AEP P/N**  
**7312-1511-000**

## Bulkhead Plug Receptacles (.093" max panel thickness)

### Straight

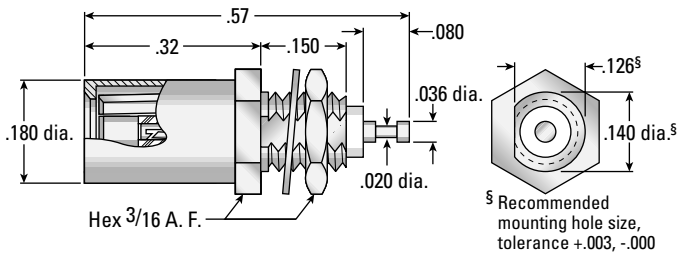

**AEP P/N**  
**7317-1512-000**

### Right angle

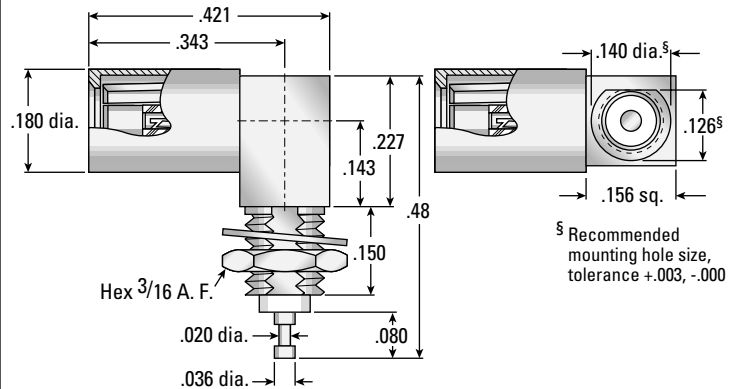

**AEP P/N**  
**7340-1511-000**

## Straight Bulkhead Plug Receptacle (.250" max panel thickness)

### Recessed mount

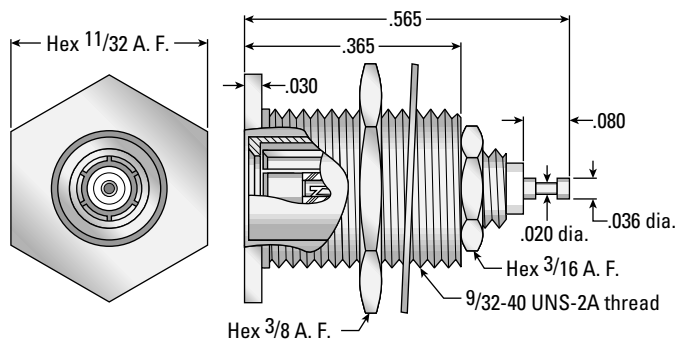

**AEP P/N**  
**7396-1512-000**

# SSLB P.C. Board Receptacles

## Straight P.C. Board Receptacles

### Standard legs

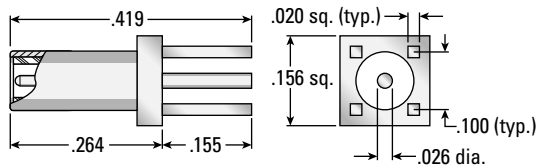

LEG FINISH	AEP P/N	LEG FINISH	AEP P/N
GOLD	7309-1511-000	PRETINNED	7309-1511-012

### Standoff legs

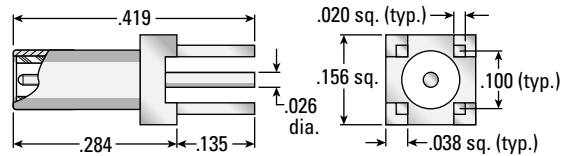

LEG FINISH	AEP P/N	LEG FINISH	AEP P/N
GOLD	7309-1511-050	PRETINNED	7309-1511-040

### Surface mount

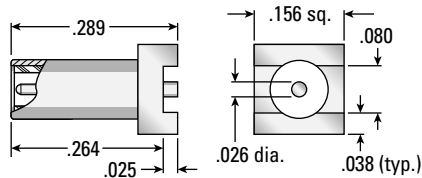

LEG FINISH	AEP P/N
GOLD	7309-1511-015

### Edge mount

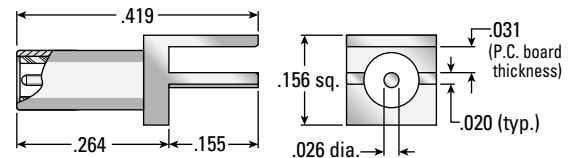

LEG FINISH	AEP P/N
GOLD	7309-1511-060

## Right Angle P.C. Board Receptacles

### Standard legs

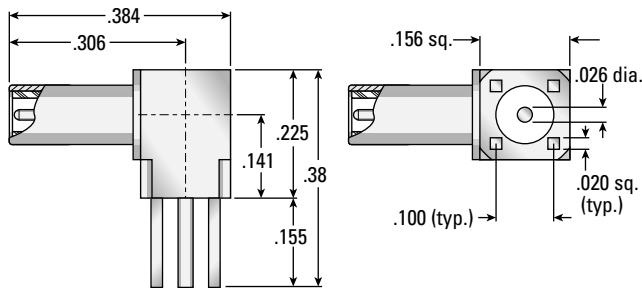

LEG FINISH	AEP P/N	LEG FINISH	AEP P/N
GOLD	7310-1511-000	PRETINNED	7310-1511-012

### Standoff legs

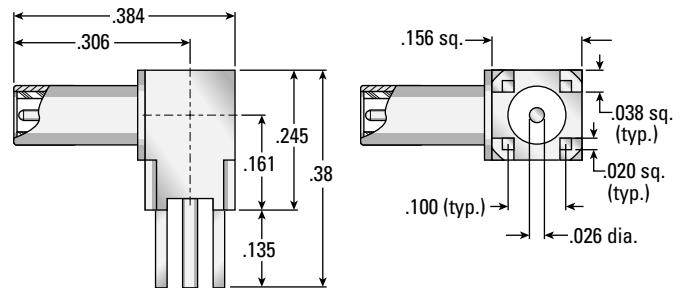

LEG FINISH	AEP P/N	LEG FINISH	AEP P/N
GOLD	7310-1511-050	PRETINNED	7310-1511-040

### Surface mount

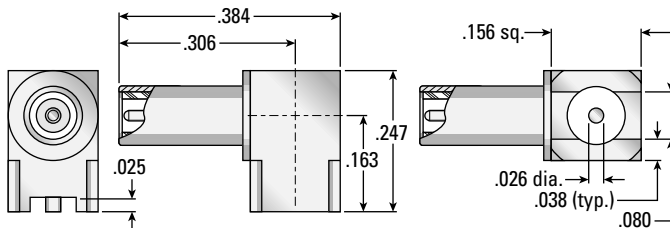

LEG FINISH	AEP P/N
GOLD	7310-1511-015

### Edge mount

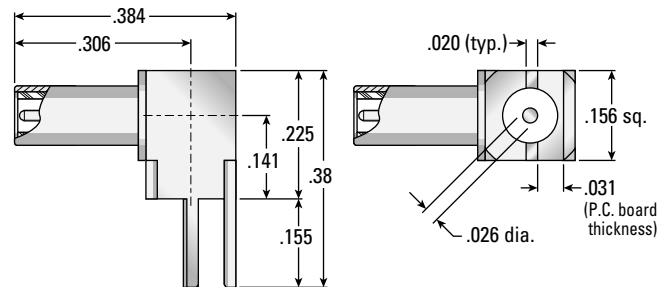

LEG FINISH	AEP P/N
GOLD	7310-1511-060

# SSLB P.C. Board Receptacles

## Straight Plug Type P.C. Board Receptacles

### Standard legs

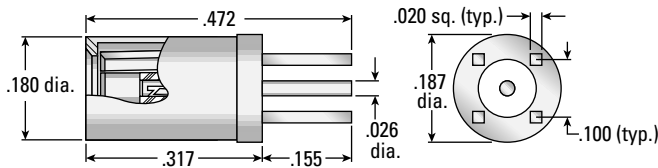

LEG FINISH	AEP P/N
GOLD	7325-1512-000

LEG FINISH	AEP P/N
PRETINNED	7325-1512-012

### Standoff legs

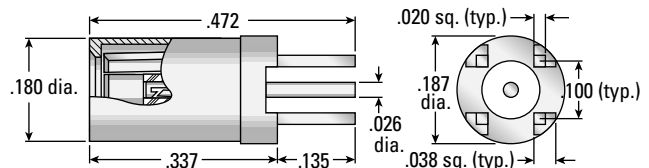

LEG FINISH	AEP P/N
GOLD	7325-1512-050

LEG FINISH	AEP P/N
PRETINNED	7325-1512-040

### Surface mount

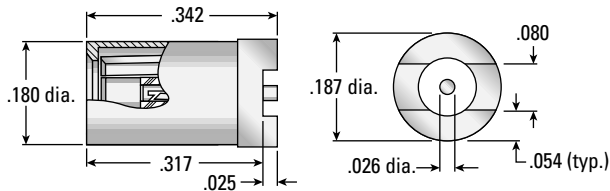

LEG FINISH	AEP P/N
GOLD	7325-1512-015

### Edge mount

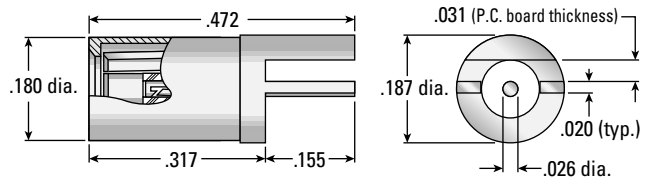

LEG FINISH	AEP P/N
GOLD	7325-1512-060

## Right Angle Plug Type P.C. Board Receptacles

### Standard legs

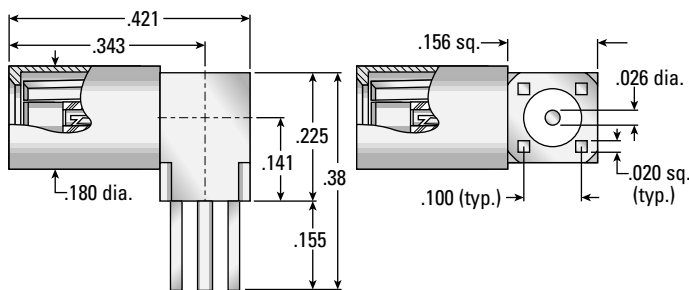

LEG FINISH	AEP P/N
GOLD	7342-1511-000

LEG FINISH	AEP P/N
PRETINNED	7342-1511-012

### Standoff legs

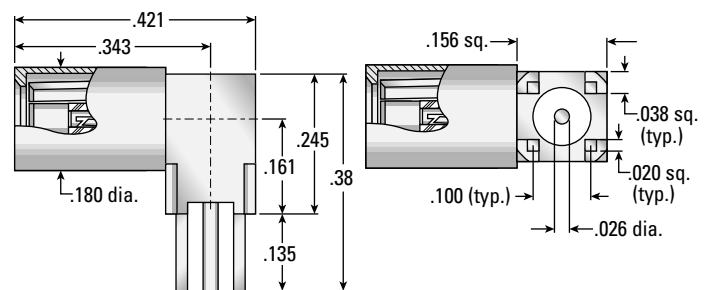

LEG FINISH	AEP P/N
GOLD	7342-1511-050

LEG FINISH	AEP P/N
PRETINNED	7342-1511-040

### Surface mount

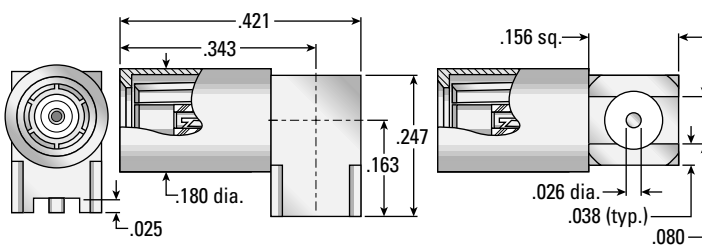

LEG FINISH	AEP P/N
GOLD	7342-1511-015

### Edge mount

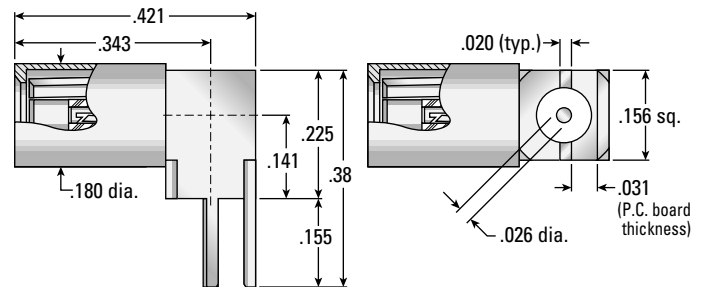

LEG FINISH	AEP P/N
GOLD	7342-1511-060



# Cable Assembly Instructions

## Straight Connectors—Flexible Cable

### Parts list

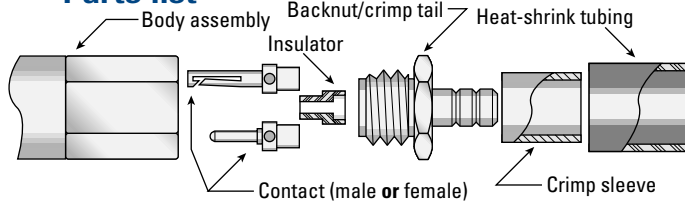

**1**

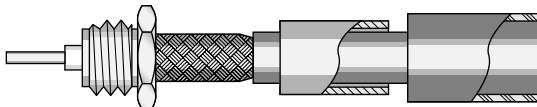

- Trim cable per trim code below; tin end of center conductor.
- Slide heat-shrink tubing and crimp sleeve over cable.
- Flare cable braid by rotating dielectric and slide cable into crimp tail.

**2**

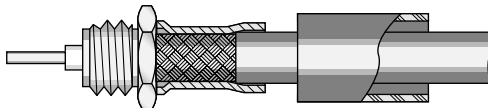

- Position cable so braid touches rear of back nut.
- Slide crimp sleeve forward to touch rear of back nut.
- Crimp braid with appropriate die size from chart below.

**3**

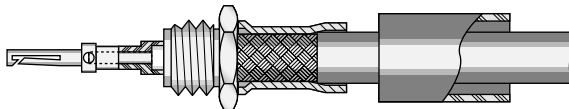

- Assemble insulator and contact onto cable dielectric and center conductor.
- Solder contact to center conductor by heating rear of contact (do not feed additional solder through inspection hole in contact).

**4**

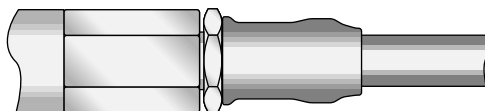

- Insert cable assembly into body assembly. Tighten to 25–45 inch-ounces torque.
- Slide shrink tubing over crimp sleeve and shrink to fit.

## Cable Trim Dimensions

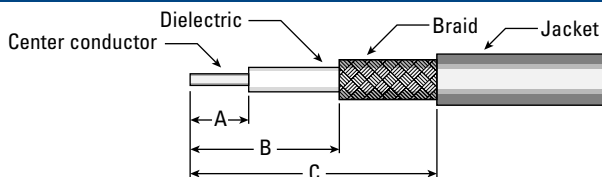

CONNECTOR TYPE	A	B	C
STRAIGHT CONNECTORS	.125	.300	.490
STRAIGHT P.C. BOARD TERMINATIONS	.060	.100	.230
RIGHT ANGLE CONNECTORS	.050	.100	.250

## Right Angle Connectors—Flexible Cable

### Parts list

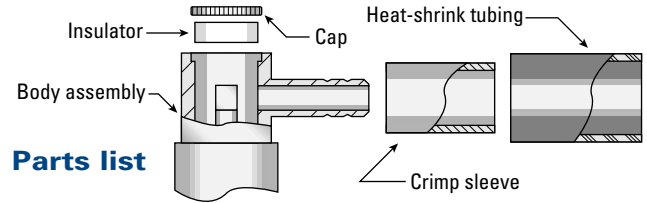

**1**

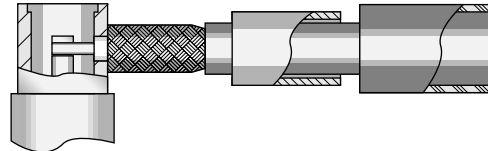

- Trim cable per trim code below; tin end of center conductor.
- Slide heat-shrink tubing and crimp sleeve over cable.
- Flare cable braid by rotating dielectric and slide cable into crimp tail.

**2**

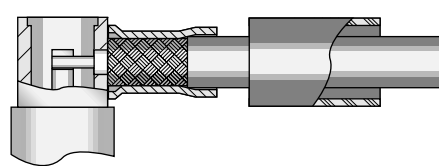

- Position cable so braid touches rear of body assembly.
- Slide crimp sleeve forward to touch rear of body assembly.
- Crimp braid with appropriate die size from chart below.

**3**

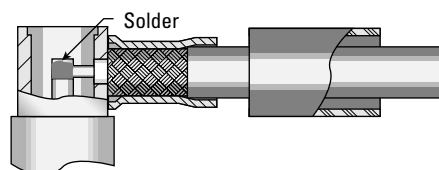

- Solder center conductor into notch in rear of contact with .025–.032" diameter chisel-tip soldering iron.
- Solder should cover center conductor, but not extend over top of notch in contact, or exceed contact diameter.

**4**

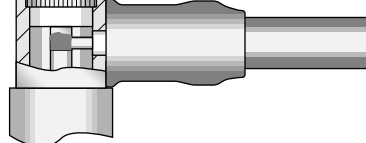

- Place insulator in body cavity, and press cap into place. Properly assembled cap will be slightly below end of body assembly.
- Slide shrink tubing over crimp sleeve and shrink to fit.

## Crimp Die Sizes

CABLE GROUP	HEX DIE SIZE
02	.105
03	.128
05	.128
19	.128

# Cable Assembly Instructions

## Straight Connectors—Semi-Rigid Cable

### Parts list

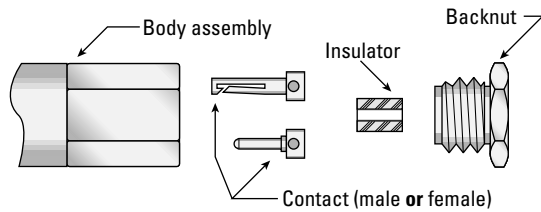

**1**

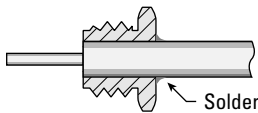

- Trim cable per trim code below; tin end of center conductor.
- Insert cable into backnut until trimmed end of jacket is flush with front of back nut.
- Solder cable jacket to back nut. Retrim dielectric flush if necessary.

**2**

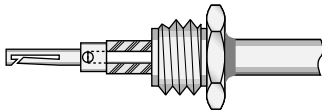

- Assemble insulator and contact onto cable dielectric and center conductor.
- Solder contact to center conductor by heating rear of contact (do not feed additional solder through inspection hole in contact).

**3**

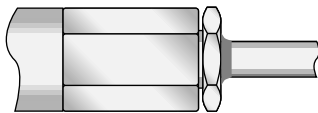

- Insert cable assembly into body assembly. Tighten to 25–45 inch-ounces torque.

## Right Angle Connectors—Semi-Rigid Cable

### Parts list

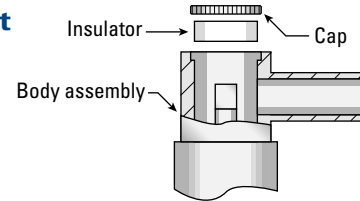

**1**

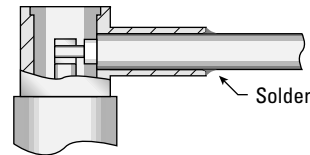

- Trim cable per trim code below; tin end of center conductor.
- Insert trimmed cable into body until jacket bottoms on step inside body and center conductor is in contact slot.
- Solder cable jacket to body assembly.

**2**

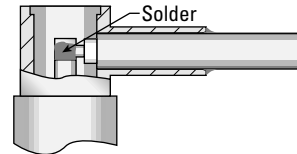

- Solder center conductor into notch in rear of contact with .025–.032" diameter chisel-tip soldering iron.
- Solder should cover center conductor, but not extend over top of notch in contact, or exceed contact diameter.

**3**

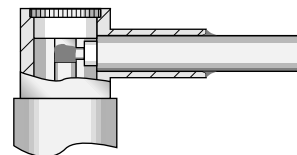

- Place insulator in body cavity, and press cap into place. Properly assembled cap will be slightly below end of body assembly.

## Cable Trim Dimensions

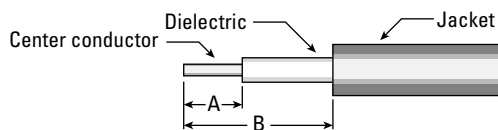

CONNECTOR TYPE	A	B
STRAIGHT CONNECTORS	.125	.125
RIGHT ANGLE CONNECTORS	.060	.120

## Assembly Tools

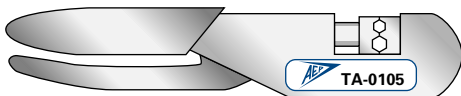

DESCRIPTION	AEP P/N
Crimp tool with .105" and .128" hex dies	TA-0105



DESCRIPTION	AEP P/N
Torque wrench with 5/32" jaws for SSMC plug coupling nuts and straight connector backnuts; 30 inch-ounces torque	TA-0432

DESCRIPTION	AEP P/N
Capping tool (arbor press) with bases for SSMB/SSMC/SSLB right angle plugs and jacks	CP-17

