

Tight-Bend Semi-Rigid Cable Assemblies

ONLINE CATALOG

Introduction

AEP's techniques for bending semi-rigid cable to a tight radius, along with innovative short plug design, produce right-angle cable assemblies with the same (or smaller) envelope dimensions as right angle SMA plugs.

Like swept right angle plugs, they provide the same performance as assemblies with straight connectors, but without the added expense of the swept connectors.

How they work:

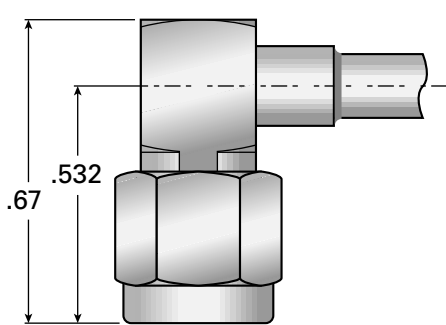

Standard right-angle SMA plug
(dimensions apply to any cable size).

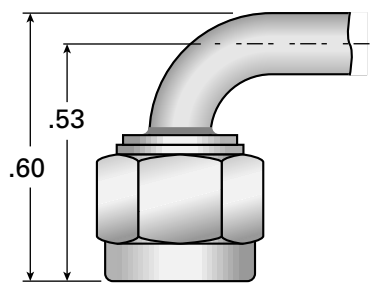

AEP Tight-Bend assembly, .141" cable
(using 9301-1063-009 connector).

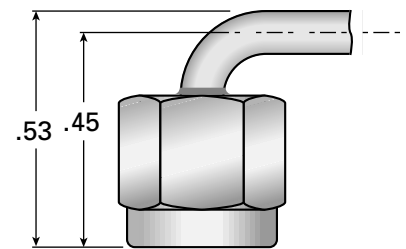

AEP Tight-Bend assembly, .085" cable
(using 9401-1083-210 connector).

AEP tight-bend assemblies can replace right-angle plugs in any semi-rigid cable assembly design—just send us your specifications for a rapid quotation.

Tight-Bend Right Angle Receptacles

Tight-bend assemblies can even replace expensive swept right-angle panel receptacles (see below), and above-panel height can be easily customized to your specific needs—unlike swept receptacles. Bulkhead and two-hole flange types are also available.

4-Hole Flange .141" semi-rigid cable	
FINISH	AEP P/N
GOLD	81-3636-XXX*
NICKEL	81-3637-XXX*

*Part number and dimensions A, B, and C determined by customer requirement.
Note: "Finish" refers to connector and flange plating; cable is tin-plated in both cases.

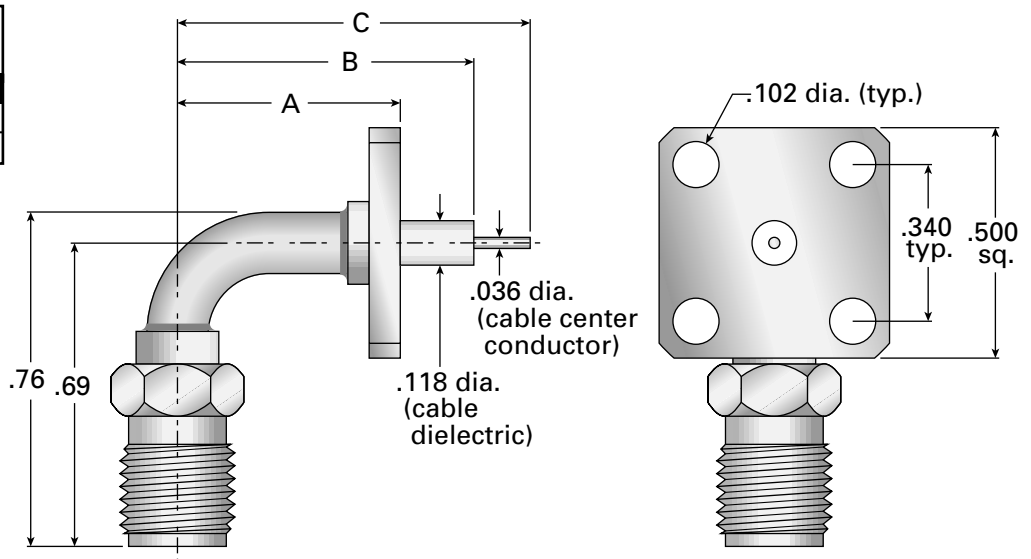

APPLIED ENGINEERING PRODUCTS

(203) 776-2813 • FAX (203) 776-8294

www.aepconnectors.com • aepsales@aepconnectors.com